

M8 Cable & Connector

Series Part No. TBD



Best Selection of Waterproof Function

Provide flexible solution for mechanical engineering for small or special industrial field, and meet the requirements of rapid and seamless connectivity within a limited space.



IP69K

Excellent environmental protection.



Connector design	Male and Female cable connector
Cable Type	Female Pin /Male Pin Straight type
Connector locking system	screw
Termination	Solder
Degree of protection	IP67/ IP69K
Cross-sectional area	TBD AWG 26-20
Cable outlet	TBD 5 mm (max)
Temperature range from/to	-40°C to +105°C
Mechanical operation	> 100 Mating cycles
Rated voltage	30V max
Rated current (40 °C)	1.5A ~ 3A (Depends on number of pins)

Component Part Drawing

Male

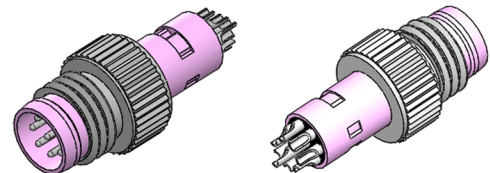

Female

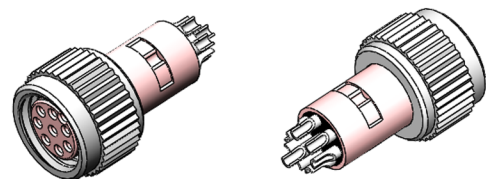

Contact arrangements

Customize for request

