

PRELIMINARY
PART IN DESIGN
SUBJECT TO CHANGE

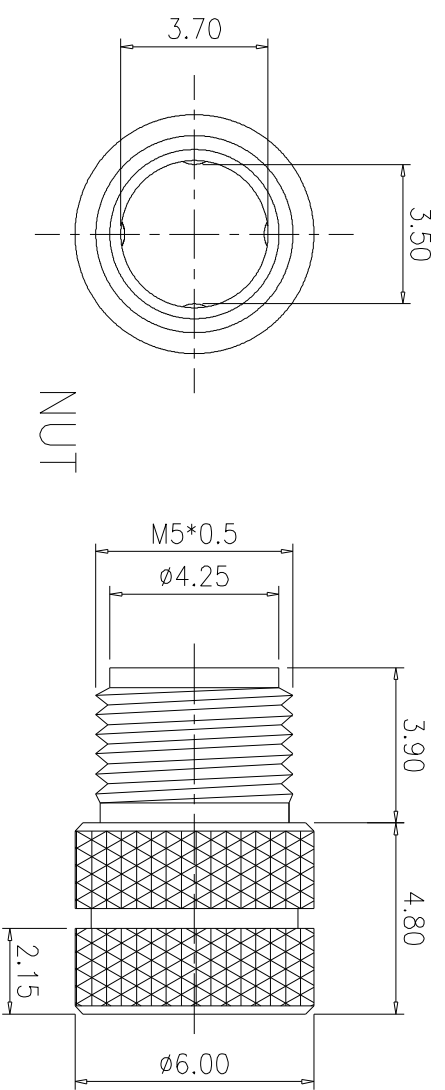
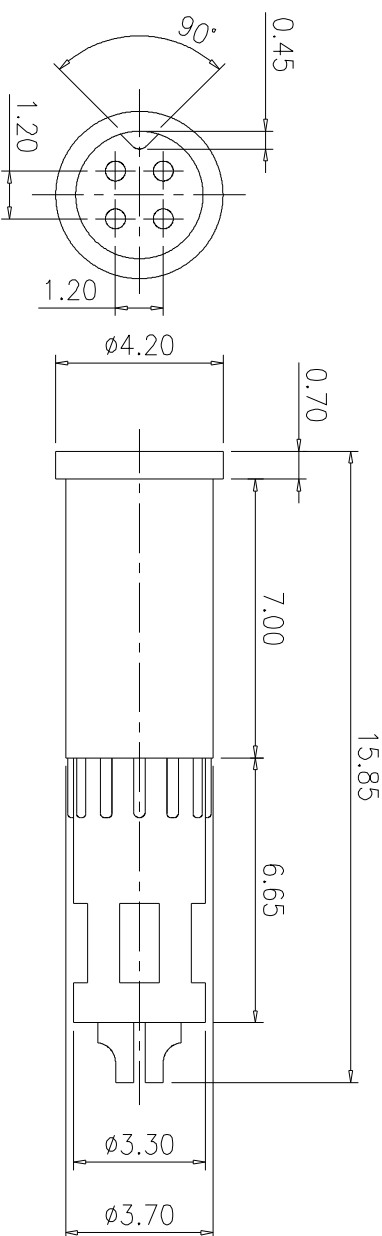

NUT

TABLE A

			H22M52-292S-SAA	Sa tin Nickel
4P	3P	2P	H22M52-392S-SAA	Sa tin Nickel
H22M52-492S-SXA	H22M52-392S-SAA	H22M52-292S-SAA	H22M52-392S-SAA	BLACK Cr
			H22M52-492S-SAA	Sa tin Nickel
			PART NO.	PLATED

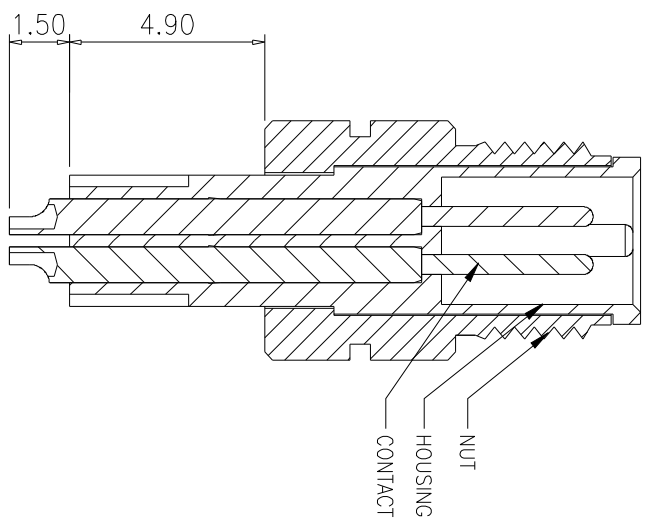

- MATERIAL :
 - HOUSING : TPU ; COLOR : BLACK
 - CONTACT : BRASS
 - NUT : BRASS
- FINISH :
 - CONTACT : GOLD FLUSH MICRO INCHES MIN.
 - NUT : SEE TABLE A.
- ELECTRICAL SPECIFICATION :
 - Rated current : 1A
 - Rated Voltage : 60V
 - Water proof: IP67
- Environmental :
 - Operation Temperature : -20°C~85°C

HALOGEN-FREE
 LEAD-FREE

UNLESS OTHERWISE SPECIFIED
 DIMENSION ARE IN MILLIMETER
 TOLERANCE ARE :
 FRACTION DECIMALS ANGLES
 .X ± 0.20 °.X ±.5°
 .XX ± 0.15 °.X ±.3°

SIMULA
 Superior Technology Solution Provider

APPROVALS	DATE	TITLE
DRAWN: Simon Wen 2015/07/31 CHECKED: Weng Zheng 2015/07/31 APPROVED: Boyton King 2015/07/31	2015/07/31	M5(M)

PART NO. H22M52-X92S-SXA
 SCALE: 5:1
 UNIT: MM
 SHEET: 1/1

CONFIDENTIAL

REV.	DCN. NO.	DESCRIPTION	ISSUED
△0.3	RFO-1508190001	NEW RELEASE	2015/07/28
	DCN-XXXXXX	NEW RELEASE	Simon Wen
	RFO-1508190001	NEW RELEASE	2015/07/31
	DCN-XXXXXX		Simon Wen

CUSTOMER